

Amana Brand Smart Thermostat Installation & Commissioning

Technical Training Module TRC-9

Amana
Home



Rest assured.
It's an Amana® brand.



© 2023 Daikin Comfort Technologies North America, Inc.
Amana® is a registered trademark of Maytag Corporation or its related companies and is used under license.
All rights reserved.

Heating & Air Conditioning
Amana

Disclaimer

This material provides technical information that is to only be used by appropriately trained and certified HVAC-R installers and technicians who have agreed to the terms and conditions available here at <https://www.daikincity.com/DaikinCityB2B TermsOfUse.html>. If you have not agreed to these terms and conditions, you may not use or view this material, and you assume responsibility for any injury or property, system or equipment damage which may result. If you have agreed to these terms, you also agree, by viewing or using this material, that this material, by its nature, cannot include a discussion of everything necessary to effect a proper installation or repair of HVAC-R equipment, nor can it address every possible scenario or environment a technician or installer may encounter. Accordingly, this material should not be considered as recommendations for best practices and will not be considered installation or repair instructions to the extent of any conflict with Daikin- or Goodman-issued manuals and specifications, or industry standards and regulations. Each installer or technician remains fully responsible for ensuring proper installation or repair of the HVAC-R equipment being worked on, and you remain fully responsible for any injury or property, system or equipment damage which may result from your installation. ©2023 Daikin Comfort Technologies North America, Inc., all rights reserved; recording, copying, or distribution of this material is prohibited without express written permission from Daikin.

Amana® is a registered trademark of Maytag Corporation or its related companies and is used under license. All rights reserved.



© 2023 Daikin Comfort Technologies North America, Inc.

2

Heating & Air Conditioning
Amana

Agenda

Amana Brand Smart Thermostat

System Configurations

Installing Amana Brand Smart Thermostat

Amana Brand Cloud Services

Commissioning (*Quality Install*)

Commissioning Amana Brand Smart Thermostat

Full Set-up

Dealer Navigation

Homeowner Navigation

Mobile Apps

© 2023 Daikin Comfort Technologies North America, Inc.

Amana
Heating & Air Conditioning

Amana Brand Smart Thermostat

- Premium control that provides optimal comfort.
- The high-resolution touch screen supports tactile-based interactions.
- Navigating to each screen is done by tapping an icon.
- Designed to regulate and communicate with HVAC equipment.
- The user will be able to control the indoor unit remotely through the Amana Brand Home app.



DAIKIN

© 2023 Daikin Comfort Technologies North America, Inc.

4

Amana
Heating & Air Conditioning

Amana Brand Smart Thermostat

- Offers two-way communication when combined with:
 - Amana Brand S-Series system; air conditioners and heat pumps, residential inverters; air conditioners and heat pumps, and two stage system; air conditioners and heat pumps.
- Serves as a cloud-connected hub and controller for communicating HVAC systems.



© 2023 Daikin Comfort Technologies North America, Inc.

5



Amana Brand Smart Thermostat

Service reminders

- Set service reminders to maintain your system.
- Preset reminder options include:
 - Media filter
 - Humidifier Pad
 - Service reminders

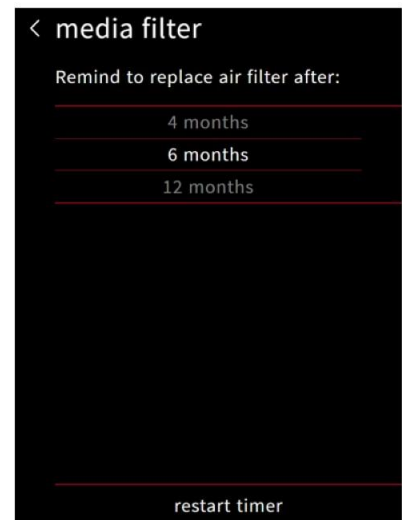
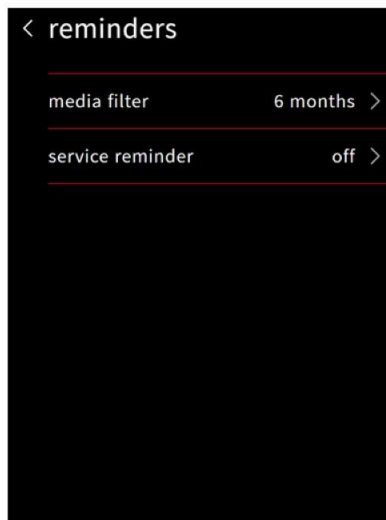

© 2023 Daikin Comfort Technologies North America, Inc.

6



Amana Brand Smart Thermostat - Messaging

- Amana Brand Smart Thermostat's messaging updates, confirms, and informs about selections you make during set-up and operation.
- There are four types of messages:
 - Status
 - Alerts
 - Reminders and Prompts
 - Learn more/tips

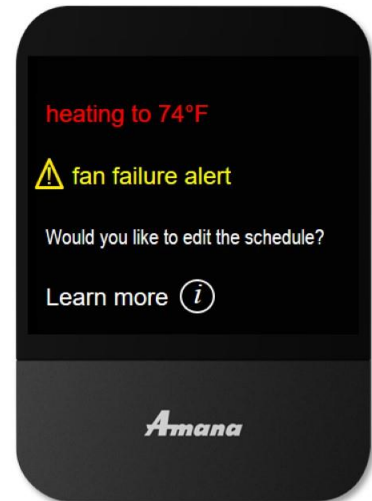

Note: Alerts have priority over all other messages in the system.



© 2023 Daikin Comfort Technologies North America, Inc.

7



Amana Brand Smart Thermostat - Quick Reference Card

- Quick reference cards are packaged with the thermostat to help answer questions during the installation and commissioning.

Dealers

Install the thermostat

Use the two included screws to secure the terminal plate to the wall. After connecting the wires, hook the top edge of the thermostat onto the holes on the top edge of the terminal plate. Rotate the thermostat down until it snaps into place. Once connected to power, follow the on-screen instructions.

Begin Setup

Use begin setup to customize settings and ensure the system is properly configured and ready for homeowners to use.



Terminal plate Screws Thermostat

Attach the thermostat to the terminal plate and snap into place.



Get help at amana-hac.com/resources

Homeowners

Install the mobile app

Monitor and control your HVAC system from across the room, or from across the country.



Available on the App Store and Google Play.



amana-hac.com/app

Learn more about your smart thermostat

Find additional information about how your smart thermostat works and download the Homeowner Guide.



amana-hac.com/smart-thermostat

Scanning the bar code on the **bottom left** corner will link you to a website related to the title of the card. <https://amana-hac.com/resources>



© 2023 Daikin Comfort Technologies North America, Inc.

8



Agenda

Amana Brand Smart Thermostat

System Configurations

Installing Amana Brand Smart Thermostat

Amana Brand Cloud Services

Commissioning

Dealer Navigation

Homeowner Navigation

Mobile Apps

© 2023 Daikin Comfort Technologies North America, Inc.

Amana
Heating & Air Conditioning

Valid System Configurations

Communicating indoor

- Air handler.
- Furnace.
- EEV coil.



Communicating outdoor

- Heat pump.
- Air Conditioning.



DAIKIN

© 2023 Daikin Comfort Technologies North America, Inc.

10

Amana
Heating & Air Conditioning

Agenda

Amana Brand Smart Thermostat

System Configurations

Installing Amana Brand Smart Thermostat

Amana Brand Cloud Services

Commissioning

Dealer Navigation

Homeowner Navigation

Mobile Apps

© 2023 Daikin Comfort Technologies North America, Inc.

Heating & Air Conditioning
Amana

Installing Amana Brand Smart Thermostat



DO NOT Install the thermostat where it can be affected by:

- Drafts or dead spots behind doors and in corners.
- Hot or cold air from ducts or ceiling fans.
- Radiant heat from the sun or appliances.
- Concealed pipes and chimneys.
- Unheated (uncooled) areas such as an outside wall.



DAIKIN

© 2023 Daikin Comfort Technologies North America, Inc.

12

Heating & Air Conditioning
Amana

Installing Amana Brand Smart Thermostat



- Mount the thermostat to be
 - Leveled.
 - Approximately 5' from the floor.
 - On an interior wall using the included screws.
- Attach the thermostat to the top of terminal plate and snap into place

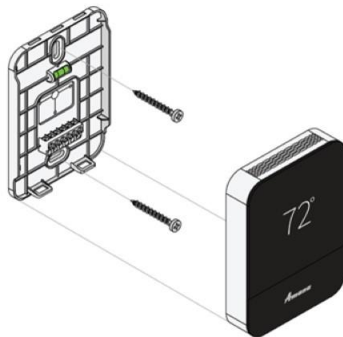

FLOOR



© 2023 Daikin Comfort Technologies North America, Inc.

13



Installing Amana Brand Smart Thermostat

82 81

Wiring thermostat to communicating systems

- Maximum wire distance between the Amana Brand Smart Thermostat and the indoor unit should not exceed **125 feet using 18 gauge wire**.
- **Check for proper voltage before and after wiring is installed.**
 - 0.6VDC between Data 1 and 2
- Wiring communicating indoor unit to communicating outdoor units.
 - Connect **1, 2, C and R** from the **Amana Brand Smart Thermostat**, to **1, 2, C and R** at the **indoor unit**.
 - Connect wires **1 and 2** from the **indoor unit** to **1 and 2** at the **outdoor unit**.
- **Note:** The Amana Brand Smart Thermostat is labeled **1, 2, C, R**. **If wired incorrectly, you will receive a communication error, or your equipment may not be recognized and displayed.**

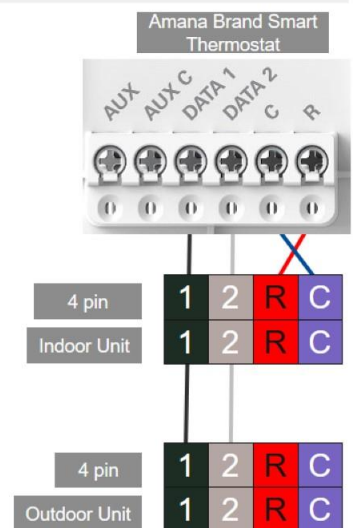

© 2023 Daikin Comfort Technologies North America, Inc.

14



Aux Wiring

- The thermostats Aux outputs are dry contacts that close the connection to turn on the Aux equipment.
- A 24V AC control signal must be routed through one of the aux contacts of the thermostat.

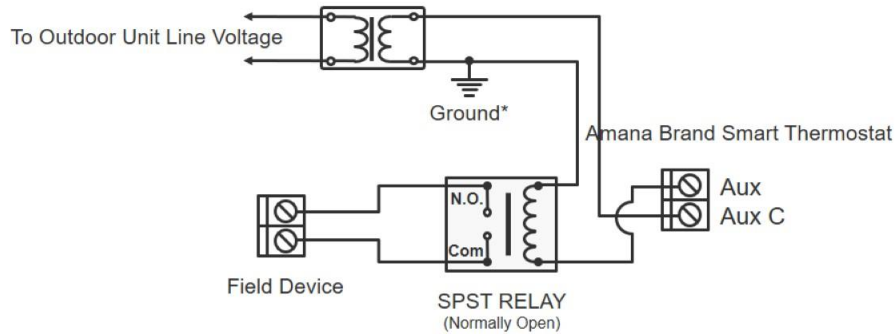

*The terminals are selected in the Amana Brand Smart Thermostat installer wizard.
Note: It is recommended to use a minimum of 18-gauge wire. Maximum operating length of wire is 125 ft.



© 2023 Daikin Comfort Technologies North America, Inc.

15



CoolCloud™ HVAC App

Download the **CoolCloud™** HVAC application

- This system is **NOT** ComfortBridge controlled. If wired to a ComfortBridge furnace that requires a critical OTA update, the installer must complete an OTA update through the CoolCloud app prior to commissioning.
- Where can I download the app?

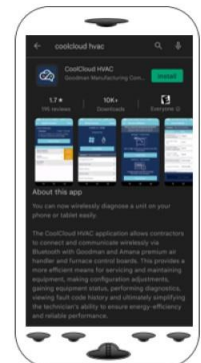

- The **CoolCloud™** HVAC app is available in **Apple®** and **Android™** versions.



© 2023 Daikin Comfort Technologies North America, Inc.

16



CoolCloud™ HVAC App

Software updates

- Once paired, available software updates will be displayed.
- Mandatory updates are required before moving forward.
- Optional updates can be downloaded or skipped.

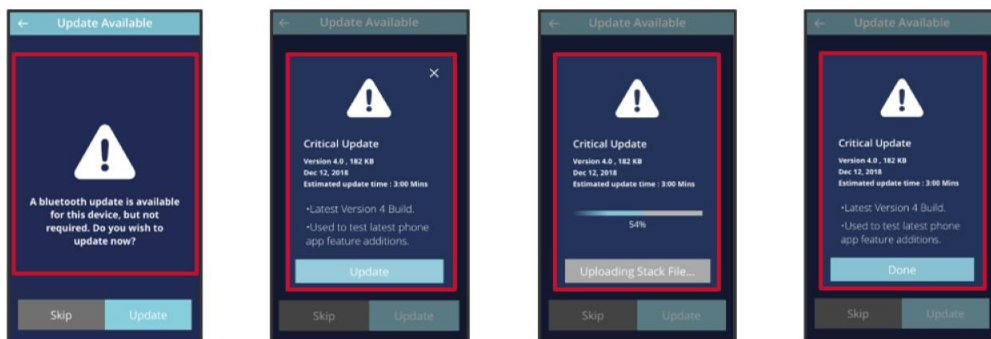

© 2023 Daikin Comfort Technologies North America, Inc.

17



CoolCloud™ HVAC App

Permissions required by application

- Access To Photos
- Bluetooth Scanning
- Device Location

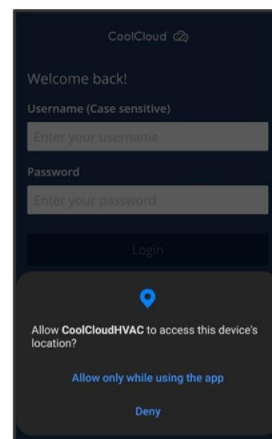
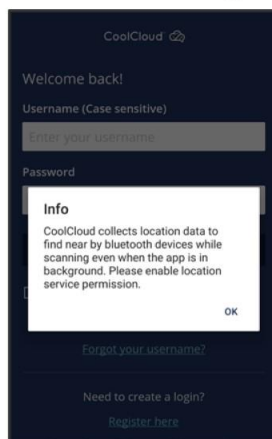
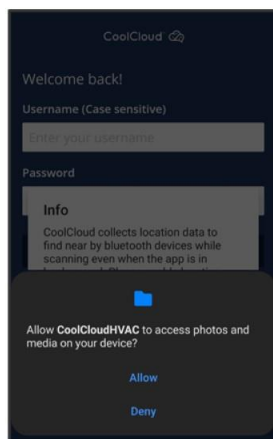

© 2023 Daikin Comfort Technologies North America, Inc.

18



CoolCloud™ HVAC App

Login and registration screens

- Log in where you have a strong cell signal or are on an available Wi-Fi network.
- Create an account to get started.
- New users will first have to register for an account by providing registration information.
 - Note: Username information cannot be edited once selected by the user.
- If a user would like to make changes to the account information a new account will need to be created.

The image shows two side-by-side screenshots of the CoolCloud HVAC App interface. The left screenshot is the login screen, titled 'Welcome back!', with fields for 'Username (Case sensitive)' and 'Password', a 'Login' button, a 'Remember your username' checkbox, and links for 'Forgot your password?' and 'Forgot your username?'. It also has a 'Need to create a login?' section with a 'Register here' link and links for 'Terms & conditions' and 'Privacy policy'. The right screenshot is the registration screen, titled 'Register by filling out the short form below.', with fields for 'First name', 'Last name', 'Company name', 'Email', 'Cell phone number' (with a '+1' country code selector), and 'Create a username (Case sensitive)'. It also has a 'Register here' link and links for 'Terms & conditions' and 'Privacy policy'.



© 2023 Daikin Comfort Technologies North America, Inc.

19



CoolCloud™ HVAC App

Connecting to equipment

- Move to proximity of the equipment, boot up the app and the indoor equipment should appear on the device screen.
- Random **Bluetooth®** equipment in range may also appear and can simply be ignored.
- If the equipment being searched for does not appear choose *Refresh* in the upper right.
- A unit may not show up if:
 - It is out of **Bluetooth** range
 - Another user is connected to the same **Bluetooth** device
 - The unit is not powered on
- Tap the desired equipment to begin the connection steps.
- Pressing *Logout* returned the user to the previous log in screen.

The image shows a screenshot of the 'Bluetooth Devices' screen in the CoolCloud HVAC App. At the top, there is a 'Logout' button and a 'Refresh' button. Below the title bar is a Bluetooth symbol and the text 'Connect to an HVAC network by selecting the model number of the indoor unit.' There are two entries in the list: 'Model Number Shown Here' and 'Serial Number Shown Here', both with a signal strength indicator and a right arrow. Below these is a device with MAC address 'cc:04:b4:0a:6a:75' and the status 'Unknown', also with a signal strength indicator and a right arrow. The 'Refresh' button is highlighted with a red box.



© 2023 Daikin Comfort Technologies North America, Inc.

20



CoolCloud™ HVAC App

Pair device by code

- Allows the user to enter the three-digit code from the circuit board's three 7-segment displays.
- Note:** The user cannot pair the device using the Amana Brand Smart Thermostat

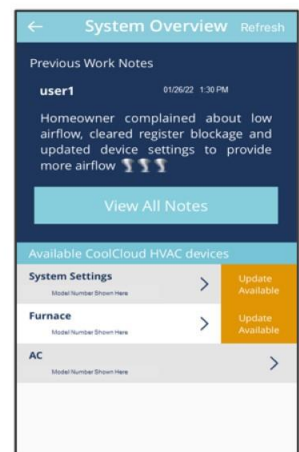

© 2023 Daikin Comfort Technologies North America, Inc.

21



CoolCloud™ HVAC App

Pairing to indoor equipment using circuit board code

- You will be prompted for a 3-digit access code shown on the three seven segment displays.

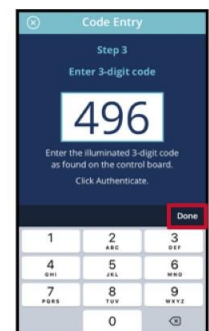
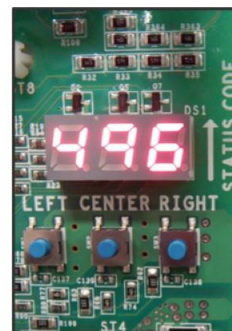

- If the code is visible, it can be entered in the Code Entry screen shown on the right.



© 2023 Daikin Comfort Technologies North America, Inc.

22



Agenda

Amana Brand Smart Thermostat
 System Configurations
 Installing Amana Brand Smart Thermostat
Amana Brand Cloud Services
 Commissioning
 Dealer Navigation
 Homeowner Navigation
 Mobile Apps

© 2023 Daikin Comfort Technologies North America, Inc.



Inviting Employees to Amana Brand Cloud Services

- In order to save profiles created utilizing the cloud service tool, you must be a member of an active Cloud Services account.
 - An email invitation to join Cloud Services will need to be accepted.

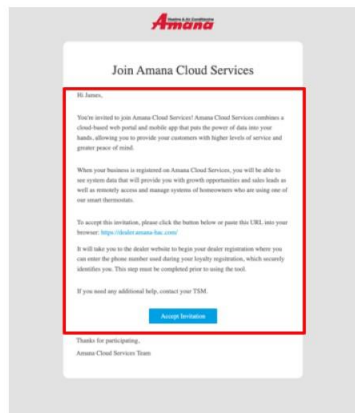

Amana Brand Smart Thermostat can be commissioned using the Amana Brand Cloud Services app without an account activated.



© 2023 Daikin Comfort Technologies North America, Inc.

24



Create Amana Brand Cloud Services Account (Dealer Employee)

1. When the employee clicks "Accept Invite" in the email they will be directed to <https://dealer.amana-hac.com>, where they will click "Sign in with Amana".
2. They will be directed to a login page, where they will click "Create Account" below the "Sign In" button.

1 

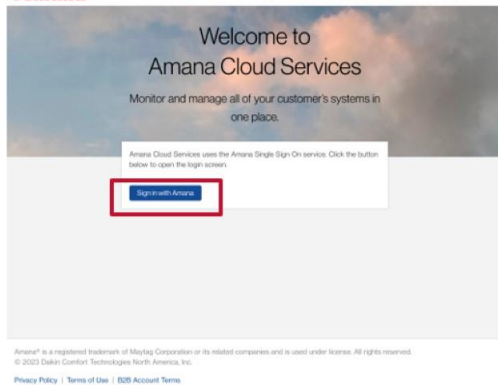

2

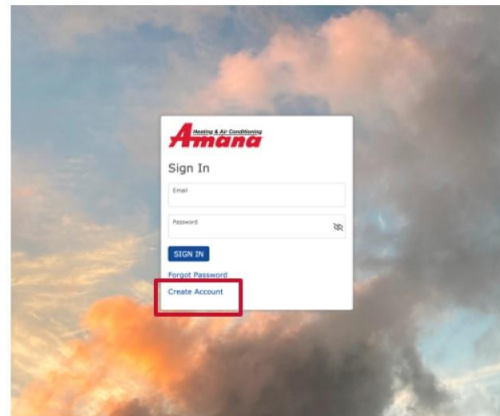

© 2023 Daikin Comfort Technologies North America, Inc.

25



Create Amana Brand Cloud Services Account (Dealer Employee)

3. The employee will be prompted to create a user login tied to the email used to invite them.
 - Complete all fields and ensure password meets criteria.
4. Employee will accept the Terms of Use and Privacy Policy, and then click "Register".

3

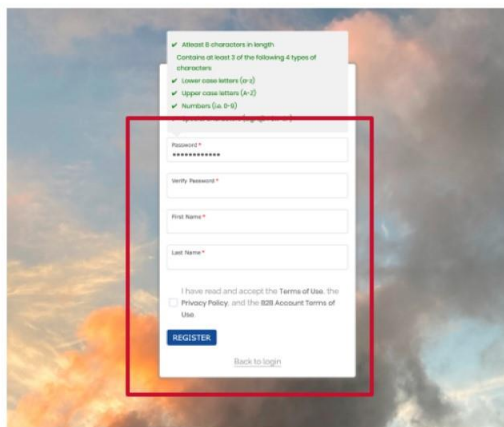

4

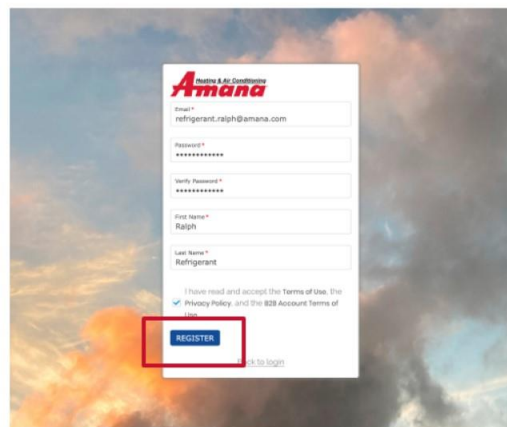

© 2023 Daikin Comfort Technologies North America, Inc.

26



Create Amana Brand Cloud Services Account (Dealer Employee)

5. The employee will receive confirmation that their account was created successfully and needs to check their email for the verification email.
6. The employee will open the email with the subject "Amana Brand Cloud Services: Verify your email" and click "Verify your account".

5

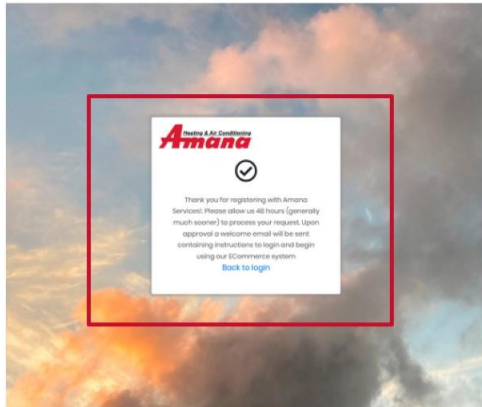

6

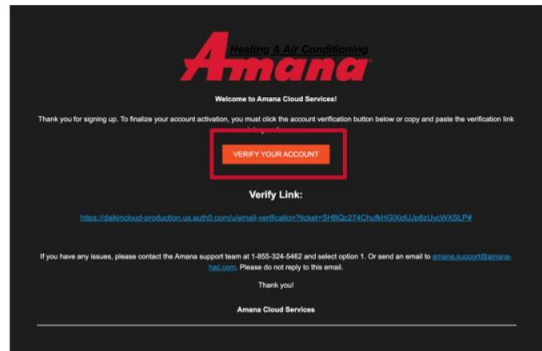

© 2023 Daikin Comfort Technologies North America, Inc.

27



Create Amana Brand Cloud Services Account (Dealer Employee)

7. The web page will provide confirmation that the email has been verified and the employee account has been created.
8. Employee will then return to <https://dealer.amana-hac.com> and enter their newly created account credentials.

7

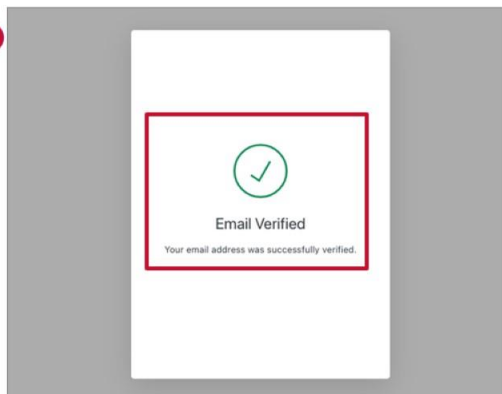

8

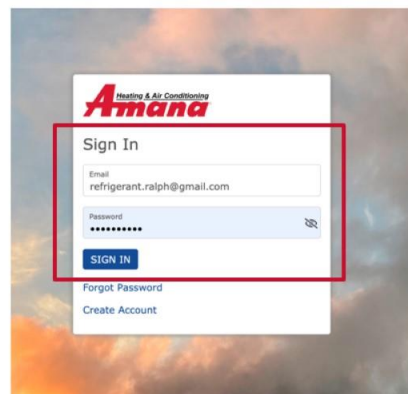

© 2023 Daikin Comfort Technologies North America, Inc.

28



Amana Brand Cloud Services: Initial Login

9. Upon your login, new users are directed to the “What’s New!” page which highlights recent feature releases, news, and updates.
10. The employee can navigate into Cloud Service by clicking on the *Dashboard*, *Customers*, or *Map* navigation icons on the left-hand navigation menu.

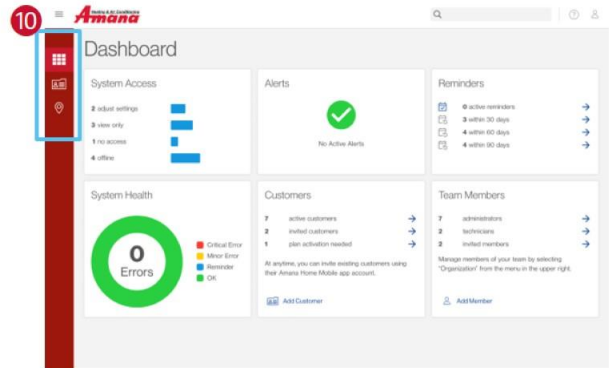
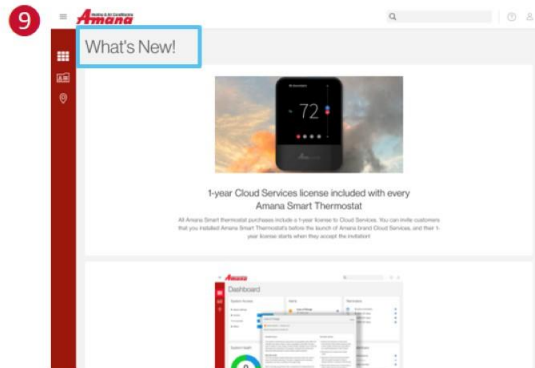

© 2023 Daikin Comfort Technologies North America, Inc.

29



Agenda

Amana Brand Smart Thermostat

System Configurations

Installing Amana Brand Smart Thermostat

Amana Brand Cloud Services

Commissioning

Dealer Navigation

Homeowner Navigation

Mobile Apps

© 2023 Daikin Comfort Technologies North America, Inc.



Quality Install

- Download the Amana Brand Cloud Services app. from your respective app. store.
- You will need to create an account to log in
 - User ID and password (case sensitive)
- System profiles enable the technician to modify settings from the app. and upload those settings to the thermostat.

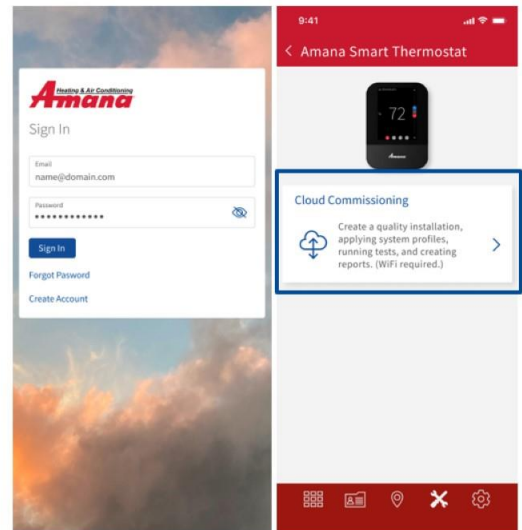

© 2023 Daikin Comfort Technologies North America, Inc.

31



Create A Job Based On Location

- Every job needs the location details.
- Click on the “+” sign to add location details and continue.
 - The user can use their GPS location to automatically fill in the address.

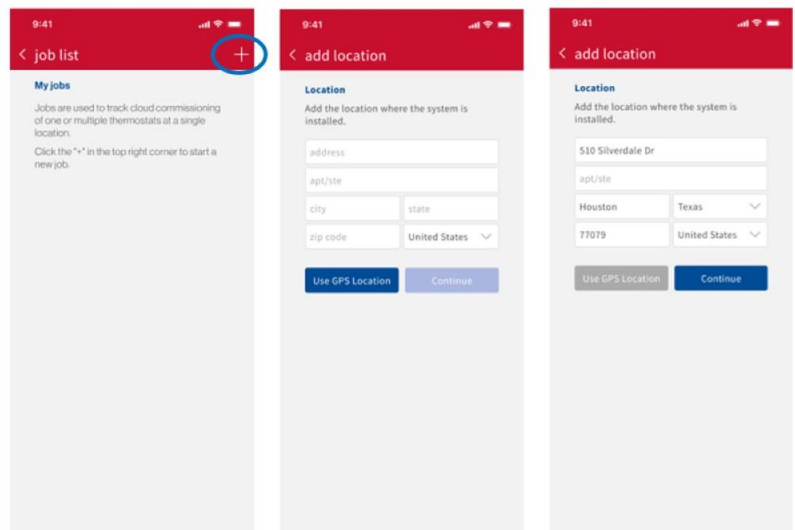

© 2023 Daikin Comfort Technologies North America, Inc.

32



Add Thermostat To Job And Configure For Zoning If Needed

- Add thermostat by tapping on + in top right corner then scanning the 2D bar code or entering thermostat DKNS # manually.
 - The 2D bar code is found on the terminal subbase.
 - DKN # is found by navigating through the thermostat setting menus.
- Zone board configuration can be seen by sliding the toggle button to the right.
 - If a thermostat is connected to a zone board and not zone one, then equipment info will not be available.

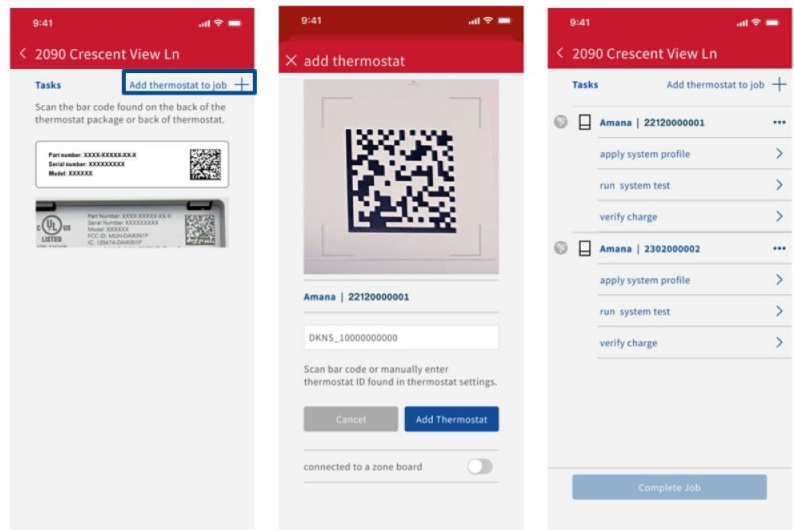

© 2023 Daikin Comfort Technologies North America, Inc.

33



Connect The Thermostat To Wi-Fi

- On selection of any task, internet connection will need to be verified before the user can continue setup.
 - If the Wi-Fi icon is grey, the system is not connected to Wi-Fi.
- To connect to Wi-Fi, first click on "apply system profile"
- On the thermostat, in the 5-step commissioning process, navigate to the communication option.
 - Check the "use Wi-Fi" option
 - Select network
 - Enter password
 - Once connected to internet: "Amana Cloud" will show connected.
 - In the app press "Continue".

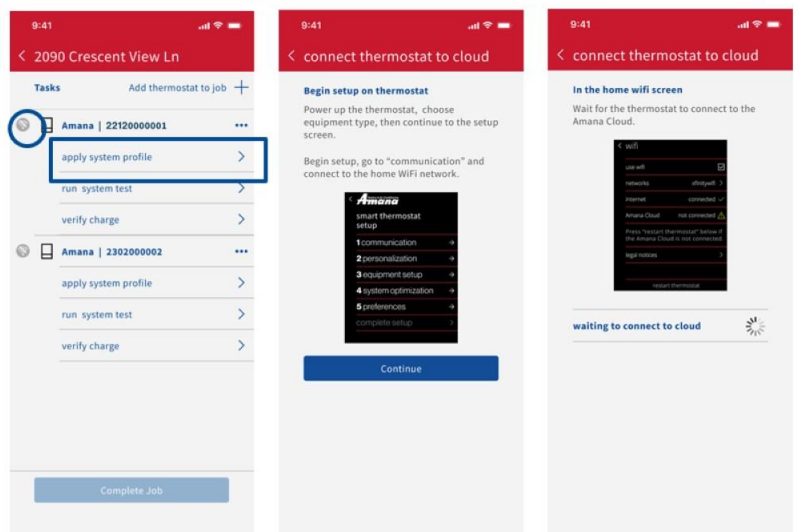

© 2023 Daikin Comfort Technologies North America, Inc.

34



Connect To Home Wi-Fi

- Once the thermostat is connected to Wi-Fi, following the “Cloud Commissioning” process, the app will automatically request access.
 - The user will then confirm the access on the thermostat UI.
 - The app receive the confirmation and automatically move to user the selected task.
- Note: If the thermostat starts to update, please allow for the update to complete before continuing

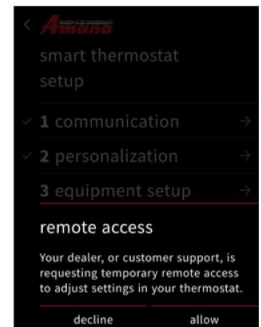
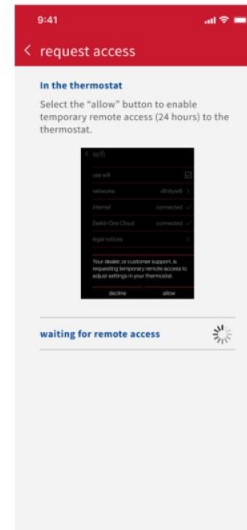

© 2023 Daikin Comfort Technologies North America, Inc.

35



Apply System Profile

- A list of the connected equipment will be populated once connected to Wi-Fi.
 - Verify equipment, then continue to view thermostat profile options.
- Once connected to Wi-Fi, the green checkmark icon will be displayed. If access is expired, then the user will see the no access icon.

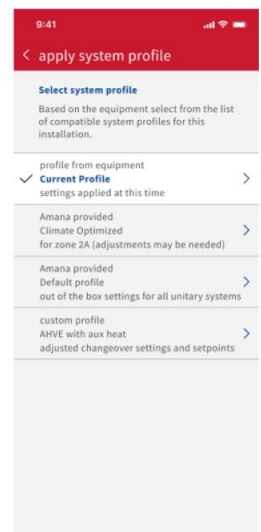
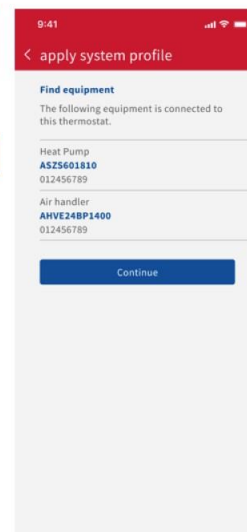
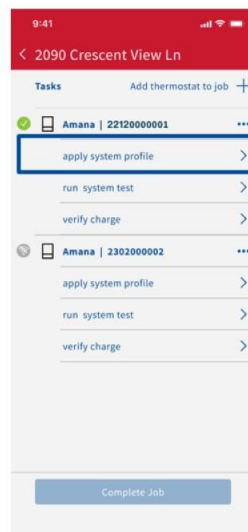

© 2023 Daikin Comfort Technologies North America, Inc.

36



Apply System Profile (continued)

- You can select and or modify any profile to send to the thermostat.

- Make edits as needed, then tap "Send to Thermostat"

NOTE: Modifying the profile does not affect the default profile

The left screenshot shows the 'apply system profile' screen with the following options:

- Select system profile: Based on the equipment select from the list of compatible system profiles for this installation.
- profile from equipment: Current profile settings applied at this time
- Amana provided: Climate Optimized for zone 2A (adjustments may be needed)
- Amana provided: Default profile out of the box settings for all unitary systems
- custom profile: AHVE with aux heat adjusted changeover settings and setpoints

The right screenshot shows the 'Climate Optimized' settings page with the following options:

- device name: main room
- Display: language: english, degree units: fahrenheit
- use large font: on
- use light bar: on
- screen saver: off
- Date & Time: time zone: Pacific, use 24-hour time format: on
- Schedule: enabled
- Send to Thermostat button



© 2023 Daikin Comfort Technologies North America, Inc.

37



Run System Test

- Running system test will prompt the user to calculate the charge before running the test.
 - Measure total line set length, then select liquid and suction line diameter before calculating required trim charge.
 - Input the actual charge weighed in.

The first screenshot shows the 'Tasks' screen for '2090 Crescent View Ln' with the following tasks:

- Amana | 22120000001: profile: current profile, run system test (highlighted), verify charge
- Amana | 23020000002: apply system profile, run system test, verify charge

The second screenshot shows the 'system test' screen with the following information:

- Charge by line set length: The outdoor unit is shipped with a predetermined factory charge level. Before starting the test it is recommended to calculate the line length and diameter to get the total recommended refrigerant weight.
- Calculate button
- Goodman cloud commissioning supports installation practices detailed in the equipment installation manual. Refer to this system's IOM for questions on proper installation.

The third screenshot shows the 'calculate charge' screen with the following information:

- total line set length: length: foot
- liquid line diameter: 5/8 inches
- suction line diameter: 3/4 inches
- Calculate button

The fourth screenshot shows the 'system test' screen with the following information:

- Charge by line set length: Required trim charge: 24 oz.
- Add refrigerant up to recommended weight into the liquid line.
- How much weight did you add? weight: oz. (input field)
- recalculate button
- Continue button



© 2023 Daikin Comfort Technologies North America, Inc.

38



Run System Test

- Verify service valves are open.
 - Tap "Run Test."
- Users can leave the screen while the test is running and return as needed.
- System test is required for inverter systems.
 - If the test has not been completed an error code "11" will be generated.
 - Error code "11" will clear once the test is complete.

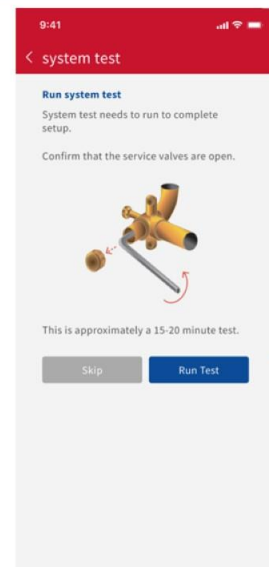

© 2023 Daikin Comfort Technologies North America, Inc.

39



Run System Charge Verification

- Recommended charge to be added to meet required charge displayed.
- Once system stabilizes and is running at full speed, the calculated subcool will be displayed.
 - Allow up to 5 min delay between gauge reading and app. verification.
 - Stopping the verification will generate a report.

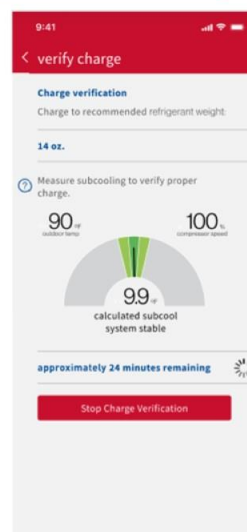
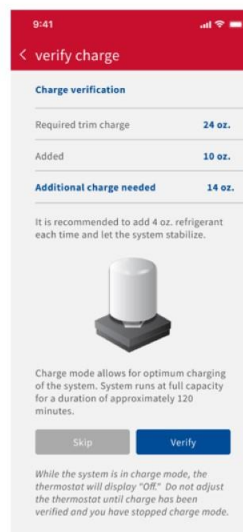
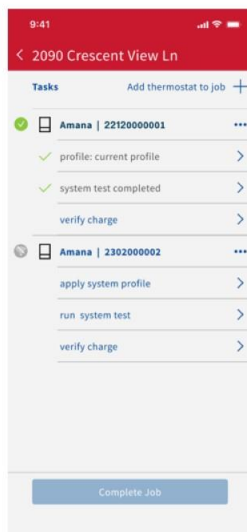

© 2023 Daikin Comfort Technologies North America, Inc.

40



Complete Setup

- After all steps are complete, the user will be able to share a commissioning report before completing the job.

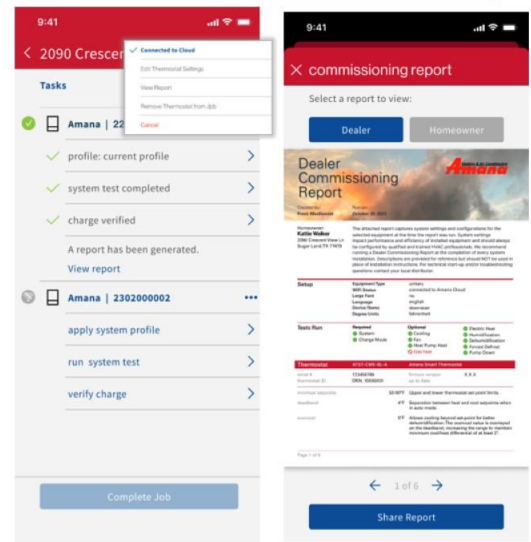

© 2023 Daikin Comfort Technologies North America, Inc.

41



Commissioning Five Step Set-up Process

- The welcome screen displays preferences to choose from.
- Begin set-up starts commissioning process to configure the system.
 - Enables random access to any setting.
 - Remembers settings as they are entered.
 - Individual may stop and restart as needed.
- Selecting setup options allows you to factory reset the thermostat.
- Version of the thermostat is displayed on the learn more screen.

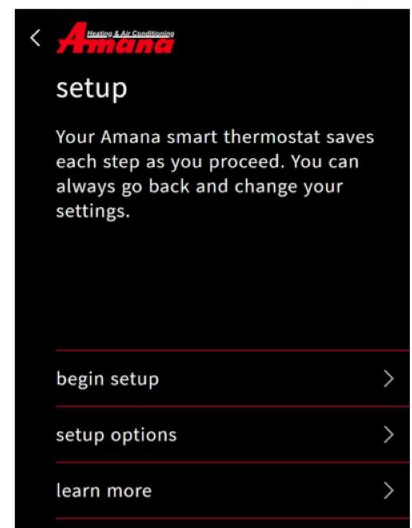
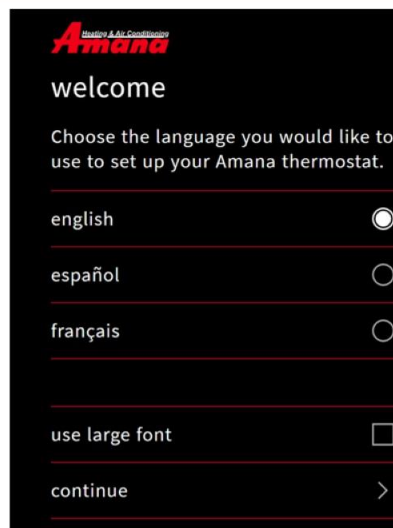

© 2023 Daikin Comfort Technologies North America, Inc.

42



Full Set-up



Start-up

▪ Tapping begin set-up starts the five step set-up process:

- Communication.
- Personalization.
- Equipment Set-up.
- System Optimization.
- Preferences.

Note: All steps must be completed and reviewed before completing set-up to ensure the system is configured properly and ready for the homeowner to use.

For detailed menu settings:

<https://amana-hac.com/resources>

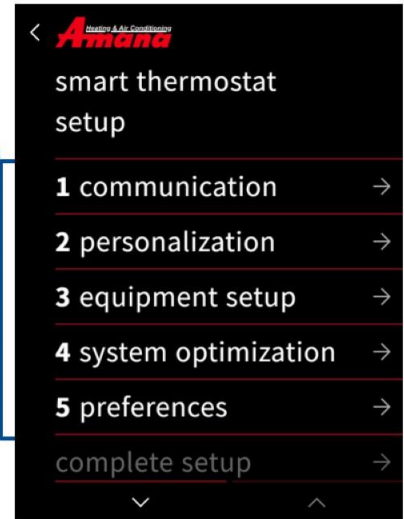

© 2023 Daikin Comfort Technologies North America, Inc.

43



Full Set-up

Step 1 - Communication

- Configures **Communication Networks**.
- Select home Wi-Fi to search for networks.
- With **Wi-Fi configured**, the system can check the software version and update software to the **latest** version **automatically**.

Note:

- A warning is generated if the router is not password protected.
 - Compatible with 5Ghz routers which supports 2.4Ghz
- Equipment type displays the equipment selected on start up.

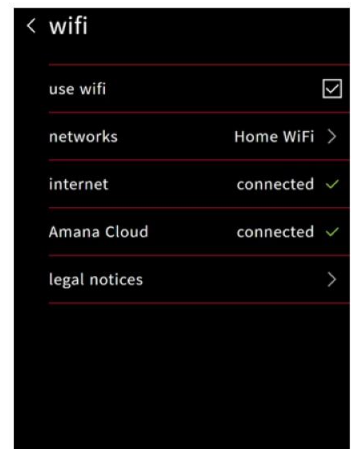
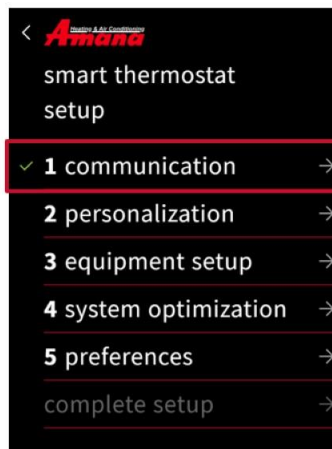

© 2023 Daikin Comfort Technologies North America, Inc.

44



Full Set-up



Step 2 - Personalization

- Tapping the **personalization** tab allows you to edit default information.
- Personalization displays:
 - Language.
 - Large font selection.
 - Date & Time.
 - If Wi-Fi is connected, date & time are set automatically.
 - Thermostat Name.
 - Degree Units.

Note: A green check mark appears next to items reviewed from the set-up menu.

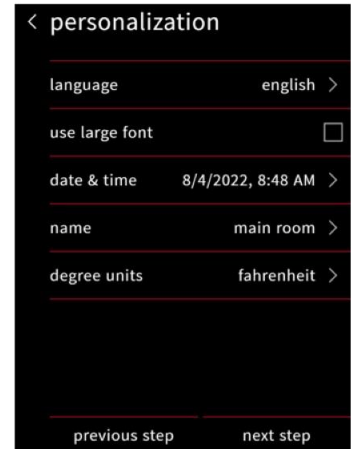

© 2023 Daikin Comfort Technologies North America, Inc.

45



Full Set-up

83

82

Step 3 - Equipment Set-up

- Displays equipment found by searching the communication network, or by adding/removing equipment and accessories from the preset list.
- The unit that is identified determines the list of configurations that will be displayed
 - View unit Specifications.
 - Configure
 - Cool settings
 - Heat Settings
 - Heat Pump Settings
 - Aux alarm
 - Heater Kit

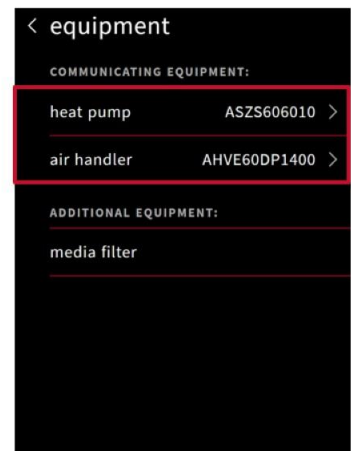
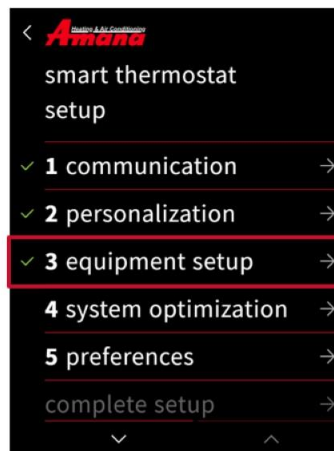

© 2023 Daikin Comfort Technologies North America, Inc.

<https://amana-hac.com/resources>

46



Amana Brand Smart Thermostat

Added equipment

- The Amana Brand Smart Thermostat is compatible with multiple accessories.
 - Humidifier
 - Dehumidifier
 - You can Install the humidifier and dehumidifier by using aux
 - Recommend using an isolation relay between auxiliary device and thermostat.
 - UV Bulb
 - Electronic Filter
 - HEPA filter
 - EWC Zone Board.

Humidifier



Dehumidifier



EWC Zone Board



© 2023 Daikin Comfort Technologies North America, Inc.

47



Full Set-up

Add equipment – auxiliary heat

- Selecting add equipment will allow you to configure an auxiliary heat source.

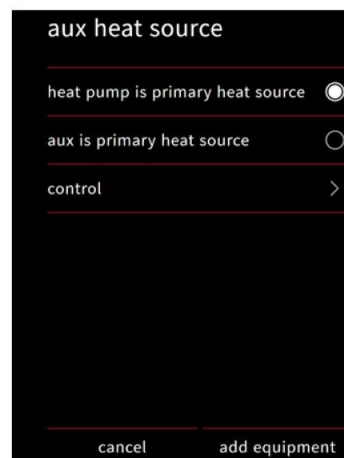
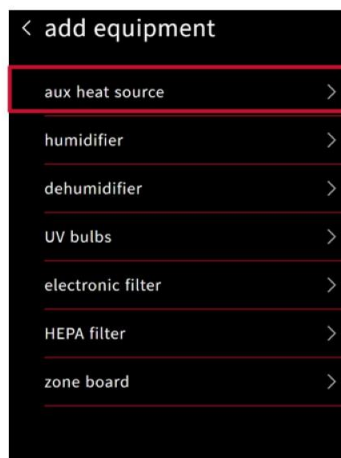
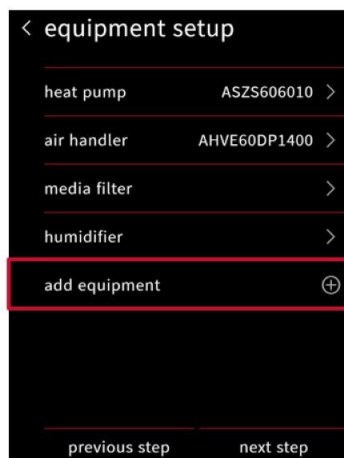

© 2023 Daikin Comfort Technologies North America, Inc.

*Aux heat source is the only control option for an AC only outdoor unit.

48



Aux Heat Setup on Amana Brand Smart Thermostat

Secondary heat settings

- The control section will allow you to adjust settings such as lockouts and secondary heat activation temperature.

*** Emergency Heat mode will appear as a system mode when connected to heat pump units and can be used to directly turn on the aux heat source if enabled.**

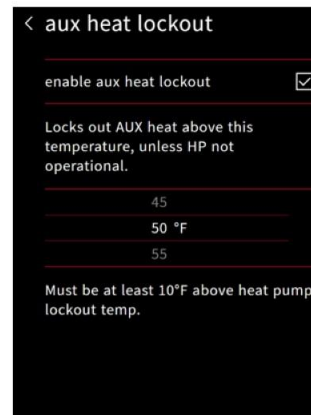
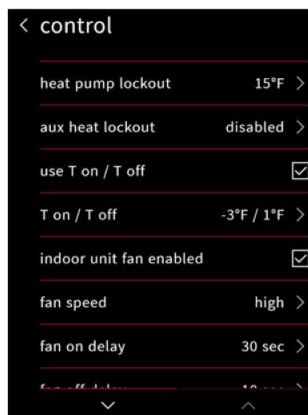

© 2023 Daikin Comfort Technologies North America, Inc.

49



T on/T off Control

- T on and T off provide an alternative control method to having the main AC/heat pump control the aux heat source using its PI control algorithm.
 - T on/T off is the only control option for aux heat with AC- only outdoor units
 - If the indoor unit is a gas furnace, or is an air handler with a heater strip, these heat sources will be controlled around the heat setpoint by the demand-based PI control algorithm.
 - When T on/T off is selected, the aux heat source will be controlled independently using these settings.

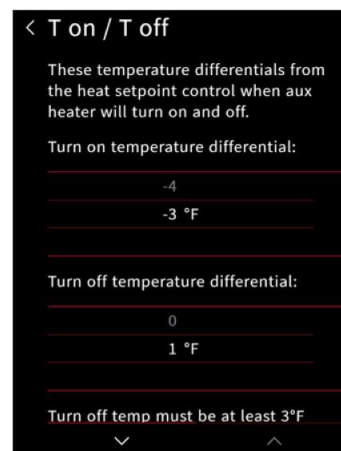

© 2023 Daikin Comfort Technologies North America, Inc.

50



Aux Heat Control

- When heat pump is the primary heat source:
 - Heat pump lockout temperatures are adjustable from -20°F to 65°F in 5°F increments. (default 15°F)
 - Auxiliary heat lockout temperatures are adjustable from -10°F to 75°F in 5°F increments. (default 50°F)

Auxiliary heat demand:

- T on differential is adjustable from -7°F to -3°F in 1°F increments (default -3°F)
- T off differential is adjustable from -4°F to 1°F in 1°F increments (default 1°F)

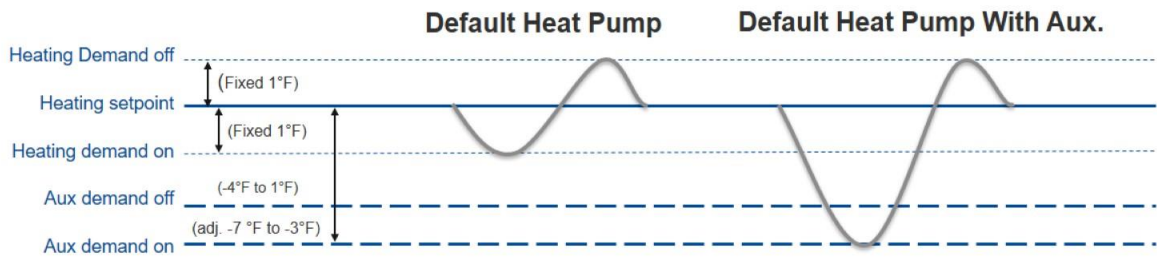

© 2023 Daikin Comfort Technologies North America, Inc.

51



Aux Heat Control

- When auxiliary heat is the primary heat source:
 - Heat pump lockout temperatures are adjustable from -20°F to 65°F in 5°F increments. (default 15°F)
 - Setpoint differential can be set at -9°F, -7°F, -4°F, and -2°F. (default -2°F)

Heat pump demand:

- T on differential can be set at -1°F or -2°F. (default -1°F)
- T off differential is fixed at 1°F.

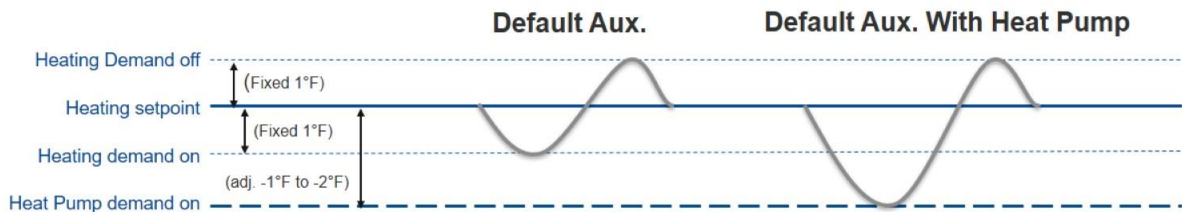

© 2023 Daikin Comfort Technologies North America, Inc.

52



Full Set-up

84 83

Step 4 – system optimization

- System optimization displays:
 - System test.
 - **Inverters only.**
 - Charge mode.
 - **Inverters only.**
 - Optional test.
 - Error history.
 - Logs alerts with an error code.
 - **White = not critical**
 - **Yellow = critical**
 - Calibration.
 - **Thermostat must be in OFF mode.**
 - **Wait 30 minutes before calibration for the thermostat to equalize.**
- Status.

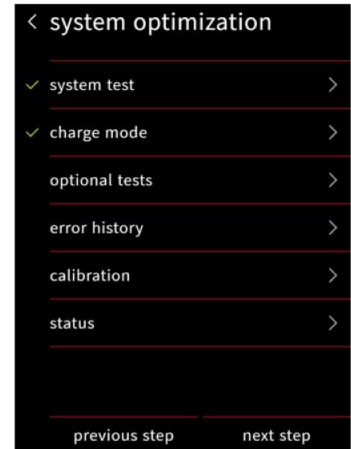
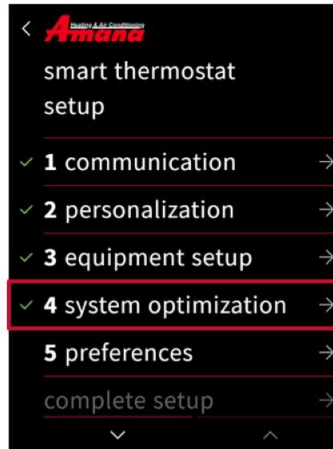

© 2023 Daikin Comfort Technologies North America, Inc.

53



Full Set-up

83 82

System test

- Running system test is required for the inverter units before proceeding to complete set-up.
 - You cannot stop this test.
- To proceed through the set-up process, the system test needs to be completed without any errors.
- When the tests are completed, the run test screen is displayed.
 - System test is complete only when display code E11 notice clears from the seven segment LED display on the heat pump or air conditioner.

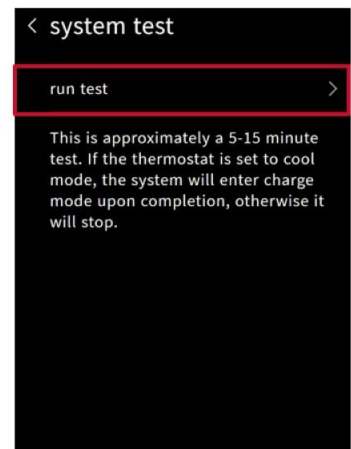

© 2023 Daikin Comfort Technologies North America, Inc.

54



Full Set-up

Charge mode

- Selecting charge mode allows for a steady system operation to allow for refrigerant charging of the system via the suction charge port.
- The system will stop when the “stop test” button is pressed or once the test is complete.

Note: For proper charging of a system, please see equipment installation manual.

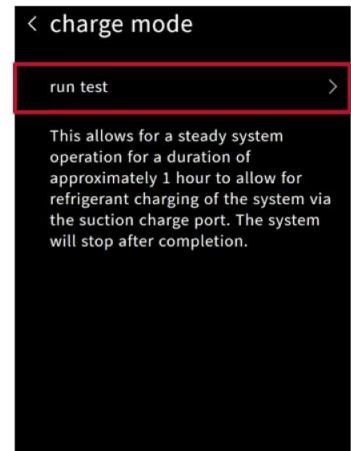

© 2023 Daikin Comfort Technologies North America, Inc.

55



Full Set-up



Optional tests

- Each optional test has a short description.
- Optional tests display a stop test button while test is running.

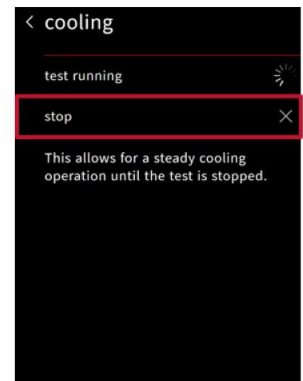
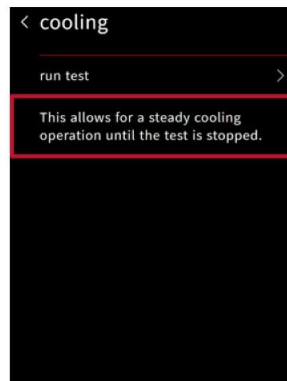

Note: Thermostat will only display tests that the system can perform.



© 2023 Daikin Comfort Technologies North America, Inc.

56



Full Set-up

Status

- The status menu displays data pertaining to the selected equipment.
- The scrollable list can be accessed any time by returning to the installer set-up screen.

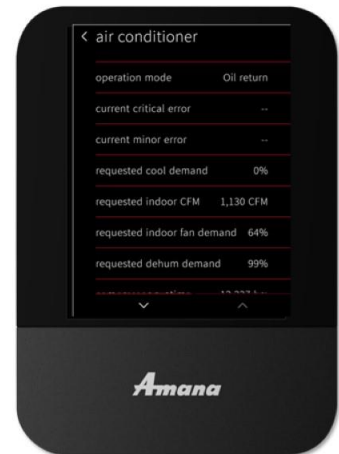
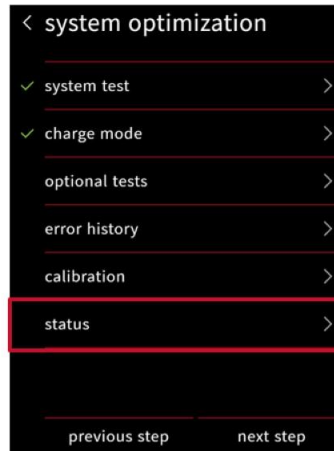

© 2023 Daikin Comfort Technologies North America, Inc.

57



Full Set-up

Step 5 - preferences

- There are four preference settings to choose from in order to optimize your systems performance.
 - Cool/Heat
 - House settings
 - Dealer information
 - Reminders

Note: Changing preferences is not required, but reminders and dealer contact information should be inputted.

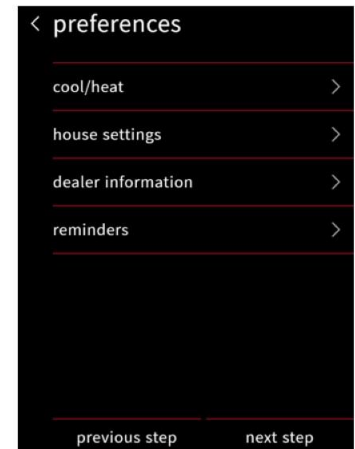
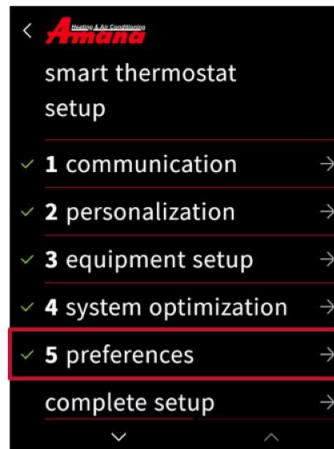

© 2023 Daikin Comfort Technologies North America, Inc.

58



Full Set-up

Dealer information

- Selecting allows you to enter and review the dealer's information.

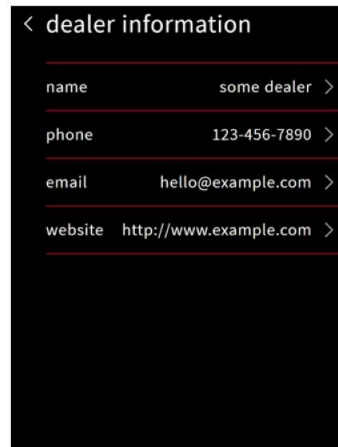
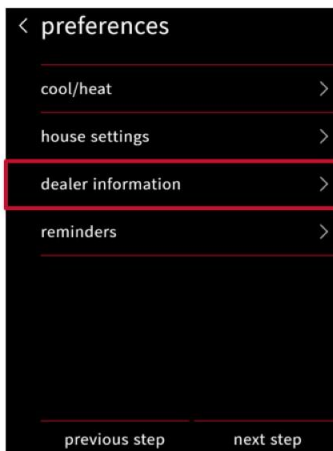

© 2023 Daikin Comfort Technologies North America, Inc.

59



Full Set-up



Reminders

- The number of reminders are based on the installed equipment with accessories.
- Once the equipment has been added, a **1 – 24-month** service reminder can be selected depending on the installed equipment.

Note: The homeowner can edit service reminders.

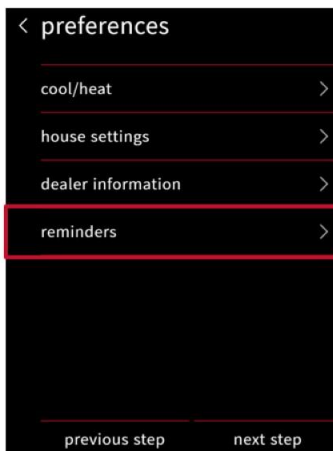

© 2023 Daikin Comfort Technologies North America, Inc.

60



Full Set-up

Final step - complete set-up

- Selecting complete set-up will conclude the full set-up of the thermostat and display normal mode for you to navigate and verify settings.

Reminder: All steps must be reviewed before completing full set-up.

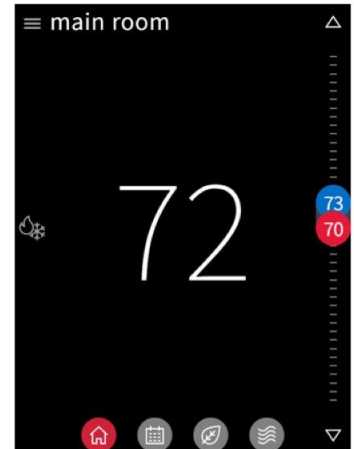
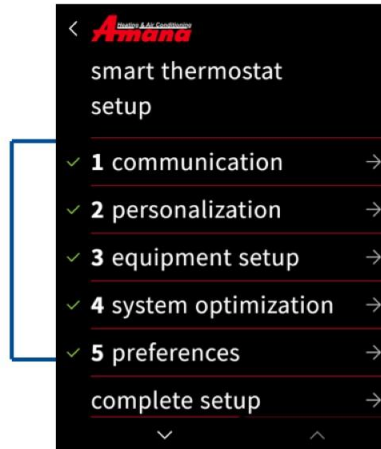

© 2023 Daikin Comfort Technologies North America, Inc.

61



Agenda

Amana Brand Smart Thermostat

System Configurations

Installing Amana Brand Smart Thermostat

Amana Cloud Services

Commissioning

Dealer Navigation

Homeowner Navigation

Mobile Apps

© 2023 Daikin Comfort Technologies North America, Inc.



Dealer Navigation

Dealer edit

- Navigating to **dealer edit** will allow you to access or revisit the installer set-up screen.
- Advanced adjustments to the Amana Brand Smart Thermostat will be made here.

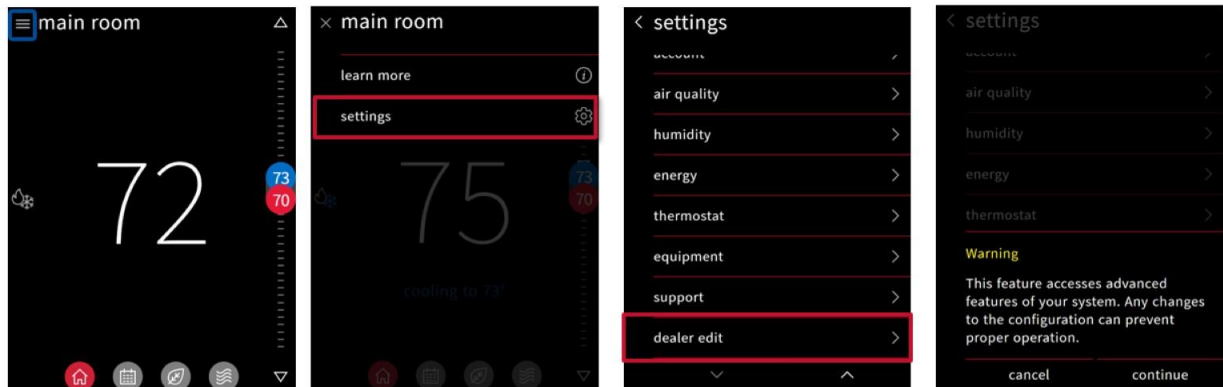

© 2023 Daikin Comfort Technologies North America, Inc.

63



Dealer Navigation

- Acknowledging the prompt enables you to tap the learn more icon.
- The icon displays the installer code, giving you access to the installer set-up screens.

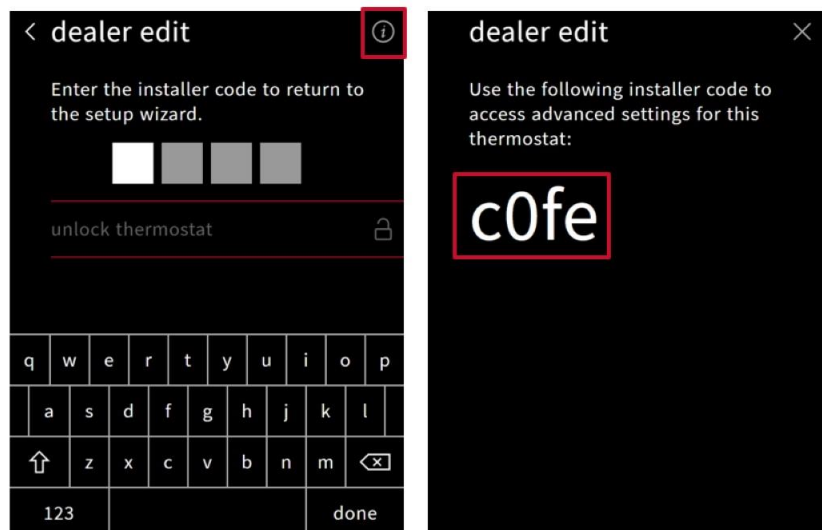

© 2023 Daikin Comfort Technologies North America, Inc.

64



Agenda

- Amana Brand Smart Thermostat
- System Configurations
- Installing Amana Brand Smart Thermostat
- Amana Cloud Services
- Commissioning
- Dealer Navigation
- Homeowner Navigation**
- Mobile Apps

© 2023 Daikin Comfort Technologies North America, Inc.

Heating & Air Conditioning
Amana

Homeowner Navigation

Normal mode

- Normal mode allows you to view messaging, temperature, and access settings to adjust parameters placed by the installer.
- Navigating is accomplished by tapping icons.

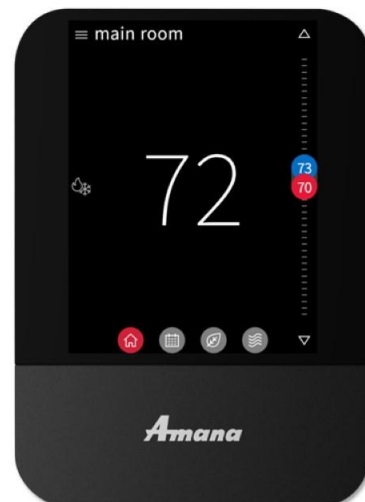

DAIKIN

© 2023 Daikin Comfort Technologies North America, Inc.

66

Heating & Air Conditioning
Amana

Homeowner Navigation

Adjust control

- Tapping the system mode icon allows you to select:
 - Auto. (cool & heat)
 - Cool.
 - Heat.
 - Off.
 - Emergency heat. (heat pump only)
- Tapping the arrow will adjust setpoints that are displayed. You can also tap, hold, and slide the setpoint icons to the desired temperature.

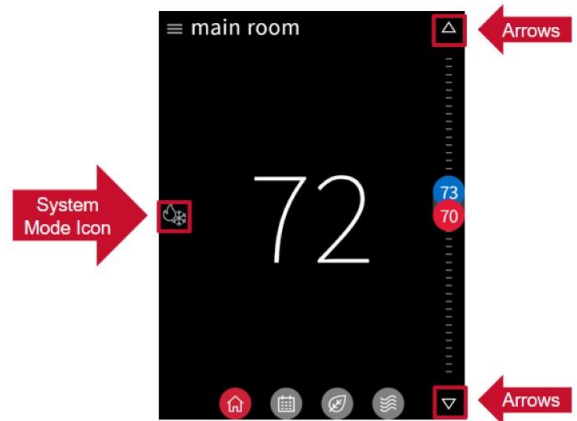

© 2023 Daikin Comfort Technologies North America, Inc.

67



Homeowner Navigation

Schedule

- The schedule is presented as 7 days, displaying one day at a time, with 24 hours fitting on the screen.
 - 4 events can be scheduled in a 24-hour period.
- You can use the drop-down menu or swipe to enable schedule editing.
- Copy and paste is a feature that makes scheduling seamless.

Note: Unlike other screens, scheduling requires saving edits before exiting the mode.

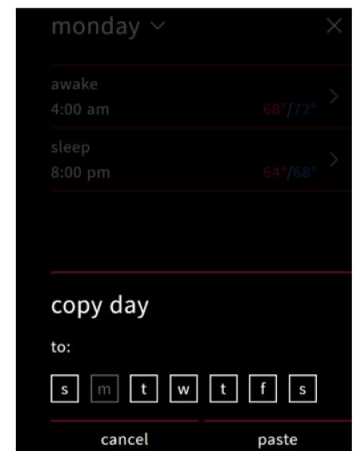
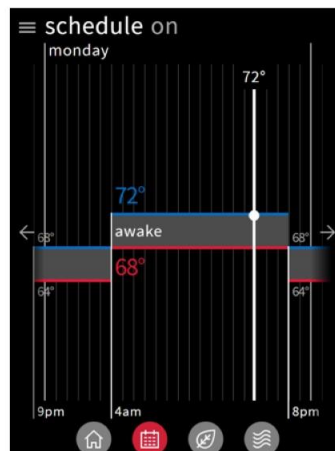

© 2023 Daikin Comfort Technologies North America, Inc.

68



Homeowner Navigation

Away

- The away screen displays the current state (on/off) and the away cooling/heating setpoints used when away is on.
 - on/off is selected from drop down menu.
- User can change the values of the setpoints by dragging the numbers or the comfort range up and down.
- With the mobile application, enabling geo-fencing will automatically switch to away mode when **outside** the radius.
 - Settings must be configured in the mobile application.

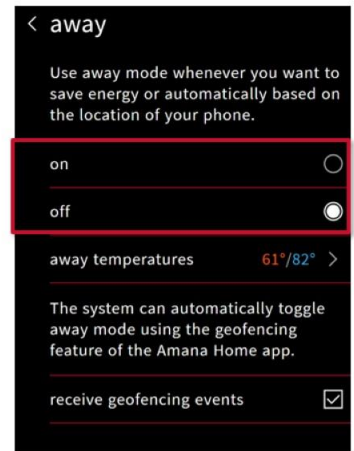
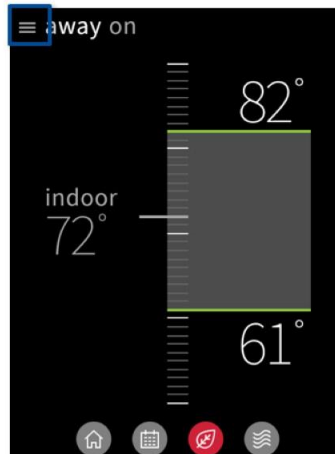

© 2023 Daikin Comfort Technologies North America, Inc.

69



Homeowner Navigation

Air quality

- The air quality screen displays **indoor air** quality levels, **outdoor air** quality, and **weather** (when connected to the internet and paired with the app.)
 - The indoor air quality is based on filter life cycle and humidity values.

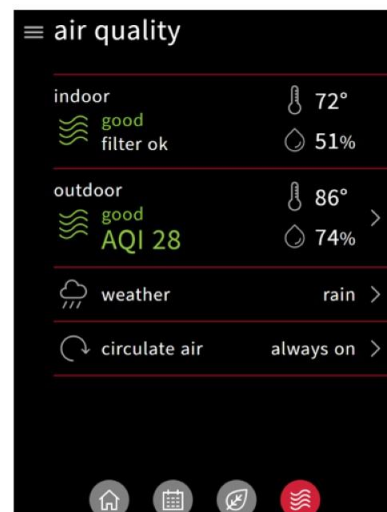

© 2023 Daikin Comfort Technologies North America, Inc.

70



Homeowner Navigation

Settings

- Settings gives you access to additional supporting features:
 - Display.
 - Adjust and enable visual features.
 - Comfort.
 - Set target humidity.
 - Configuration.
 - App. account setup
 - Dealer information
 - Date & Time
 - Enable messages/view alerts
 - System components
 - Home Wi-Fi

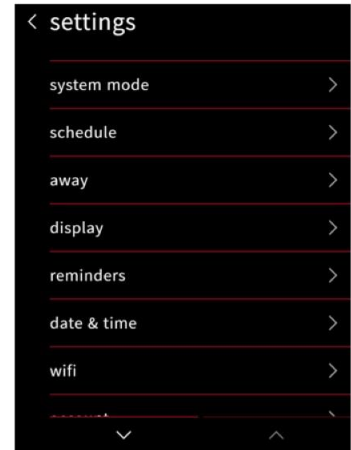
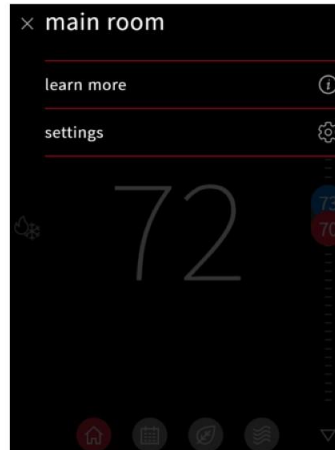

© 2023 Daikin Comfort Technologies North America, Inc.

71



Agenda

Amana Brand Smart Thermostat

System Configurations

Installing Amana Brand Smart Thermostat

Amana Cloud Services

Commissioning

Dealer Navigation

Homeowner Navigation

Mobile Apps

© 2023 Daikin Comfort Technologies North America, Inc.



Account Set-up

- Setting up an account is a four-step process.
 1. Downloading the application from your IOS or Android application store.
 - Creating the account.
 2. Confirming your account.
 3. Adding the thermostats' location.
 4. Connecting the app to the thermostat.

Note: A mobile device, the Amana Brand Smart Thermostat connected to Wi-Fi that is wired to a communicating system and a valid email address is needed to create a mobile account.

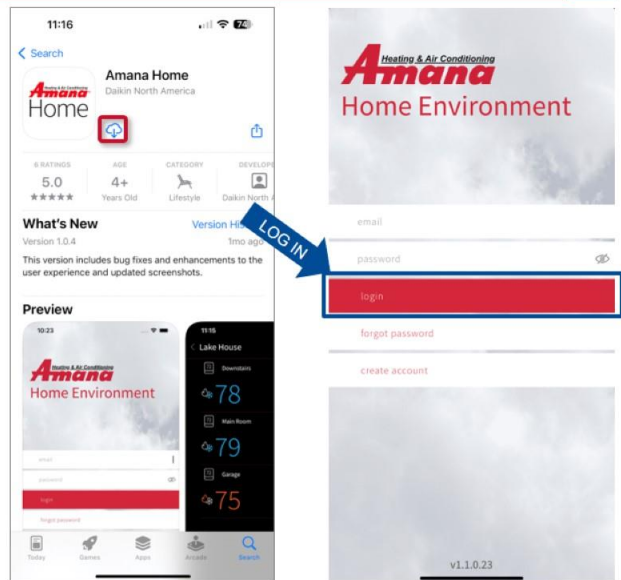

© 2023 Daikin Comfort Technologies North America, Inc.

73



Step 1 - Create The Account

- Tapping create account button of the login screen will start the process.
- Before agreeing, read the terms and service, privacy statement, and other notices.
- Fill in your name, valid email address, and password.

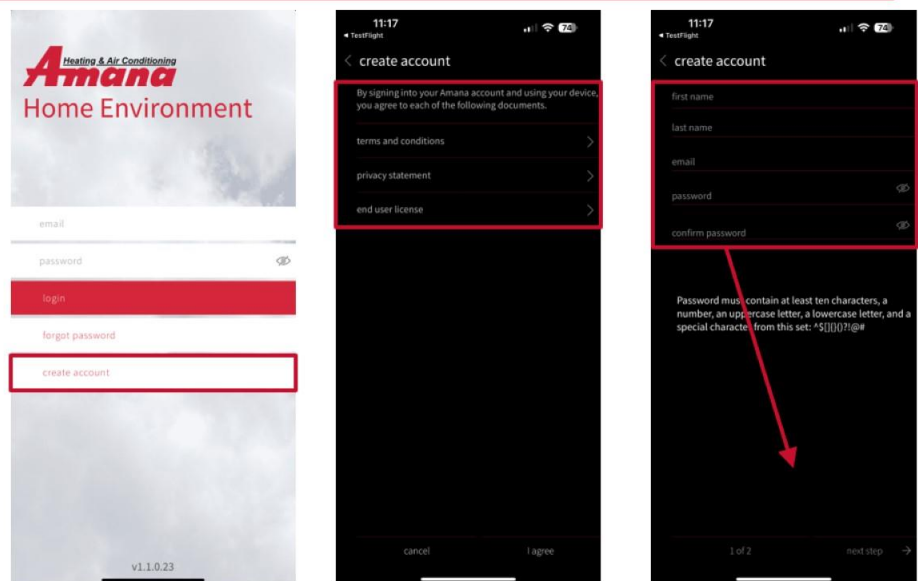

© 2023 Daikin Comfort Technologies North America, Inc.

74



Step 2 - Confirming The Account

- You will be prompted to access the email address you provided when creating the account.
- A welcome email will appear in your inbox providing a six-digit code.
- Entering the six-digit code on your phone app. will allow you to continue.

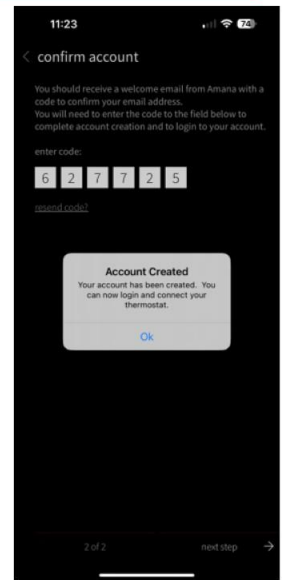
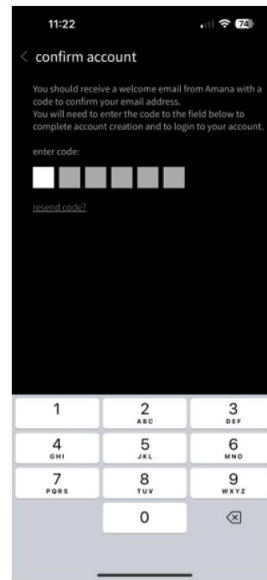
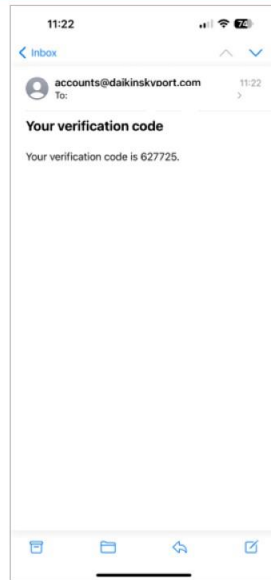

© 2023 Daikin Comfort Technologies North America, Inc.

75



Step 3 - Adding The Thermostats Location

- Enter the email and password associated to your mobile account and tap the login button.
 - If you have forgotten your password, tap the forgot password link to recover information via email.
- Type the location name and address of where the thermostat is located to gather accurate information.

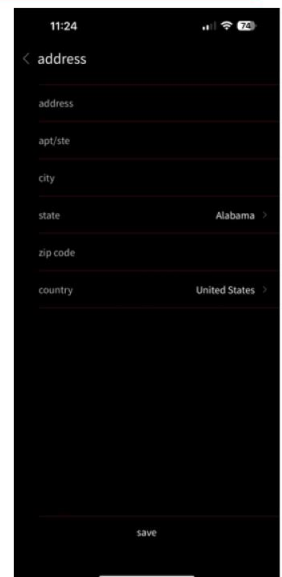
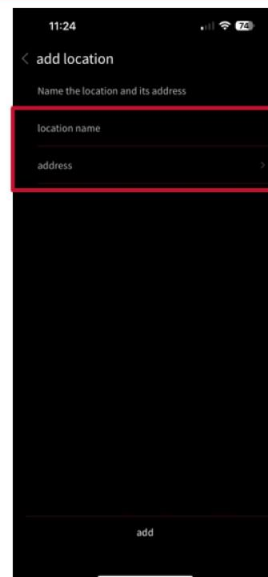
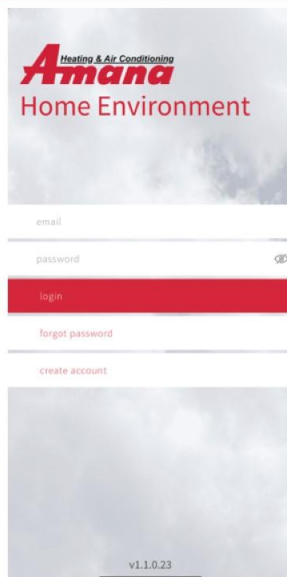

© 2023 Daikin Comfort Technologies North America, Inc.

76



Step 4 - Connecting The App. To The Thermostat

- With Wi-Fi enabled on your thermostat, access your account to retrieve the six-digit code.
- Type the six-digit code displayed on your thermostat into the space provided on the mobile app.
- Tap connect to continue and operate the Amana Brand Smart Thermostat from your mobile device.

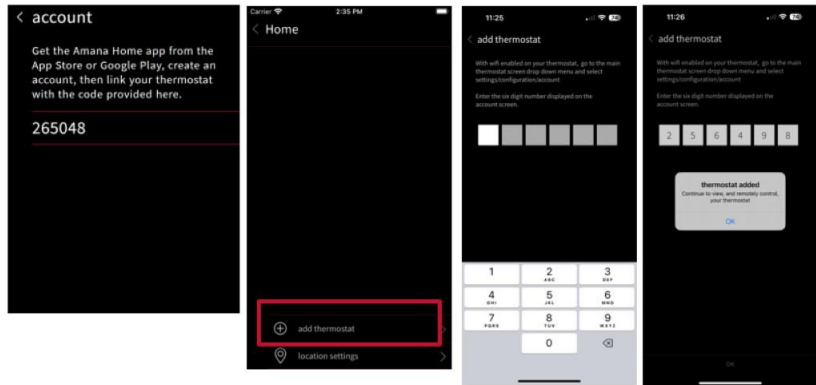

© 2023 Daikin Comfort Technologies North America, Inc.

77



Mobile App.



Visit <https://amana-hac.com/resources> for additional information



© 2023 Daikin Comfort Technologies North America, Inc.

78



Assessment

TRC-9 Amana Brand Smart Thermostat Installation & Commissioning

Rest assured.
It's an Amana® brand.



© 2023 Daikin Comfort Technologies North America, Inc.
Amana® is a registered trademark of Maytag Corporation or its related companies and is used under license.
All rights reserved.



Assessment

1. When commissioning the Amana Brand Smart Thermostat through full setup, what steps need to be reviewed before completing the setup?
 - a) All steps. ●
 - b) Communication and system optimization. ●
 - c) Personalization, communication, and preferences. ●
 - d) Equipment setup and communication. ●
2. A _____ month service reminder can be selected depending on the installed equipment.
 - a) 1-6. ●
 - b) 1-9. ●
 - c) 1-3. ●
 - d) 1-24. ●
4. How high on an interior wall should the Amana Brand Smart Thermostat be mounted?
 - a) 3' ●
 - b) 4' ●
 - c) 5' ●
 - d) 6' ●



© 2023 Daikin Comfort Technologies North America, Inc.

80



Assessment

4. Communicating indoor units with a 4-pin connector supplied, will match ____ on the 4 pin with ____ on the indoor PCB.
- a) R, C, G, W1 / R, C, G, W1 ●
 - b) R, C, W1, Y1 / R, C, G, W1 ●
 - c) G, W1, W2, Y1 / 1, 2, R, C ●
 - d) 1, 2, R, C / 1, 2, R, C ●
5. Do not install the Amana Brand Smart Thermostat where it can be affected by radiant heat from the sun or appliances.
- a) True ●
 - b) False ●
6. Measurement between data line 1 and 2 should read
- a) 0.06VDC ●
 - b) 24VAC ●
 - c) 0.6VAC ●
 - d) 0.6VDC ●



© 2023 Daikin Comfort Technologies North America, Inc.

81



Assessment

7. The maximum wire distance between the Amana Brand Smart Thermostat and the indoor unit should not exceed 150 feet using 18-gauge wire.
- a) True ●
 - b) False ●
8. At minimum, the system test should be run on inverter units before proceeding to complete the installation.
- a) True ●
 - b) False ●
9. The unit that is identified determines the list of configurations that will be displayed.
- a) True ●
 - b) False ●



© 2023 Daikin Comfort Technologies North America, Inc.

82



Assessment

10. Which set-up tab allows you to add equipment?

- a) Personalization
- b) System optimization
- c) Equipment setup
- d) Communication



11. Wait ___ minutes before calibration for the thermostat to equalize.

- a) 10
- b) 20
- c) 30
- d) 40



12. The system test can run for approximately _____ minutes.

- a) 2-4
- b) 4-6
- c) 5-10
- d) 5-15



© 2023 Daikin Comfort Technologies North America, Inc.

83



Assessment

13. Which symbol indicates a step has been reviewed?

- a) !
- b) ✓
- c) #
- d) x



14. Once you start an optional test from the thermostat it cannot be stopped.

- a) True
- b) False



15. Error history logs alerts that are color coded, ___ being non-critical and ___ being critical.

- a) Green, Yellow
- b) Blue, White
- c) White, Yellow
- d) Yellow, Red









© 2023 Daikin Comfort Technologies North America, Inc.

84



Assessment

16. The version of the thermostat is displayed on the learn more screen.
- a) True. 
 - b) False. 
17. What is needed to create a mobile account?
- a) The Amana Brand Smart Thermostat, a Tablet, and a valid email address. 
 - b) A mobile device, the Amana Brand Smart Thermostat connected to Wi-Fi that is wired to a communicating system and a valid email address is needed to create a mobile account. 
 - c) An indoor unit, an outdoor unit and the Amana Brand Smart Thermostat. 
 - d) A mobile device connected to connected to Wi-Fi, an indoor unit and an outdoor unit. 



© 2023 Daikin Comfort Technologies North America, Inc.

85

